

MATERIAL PROCESSING NOTES

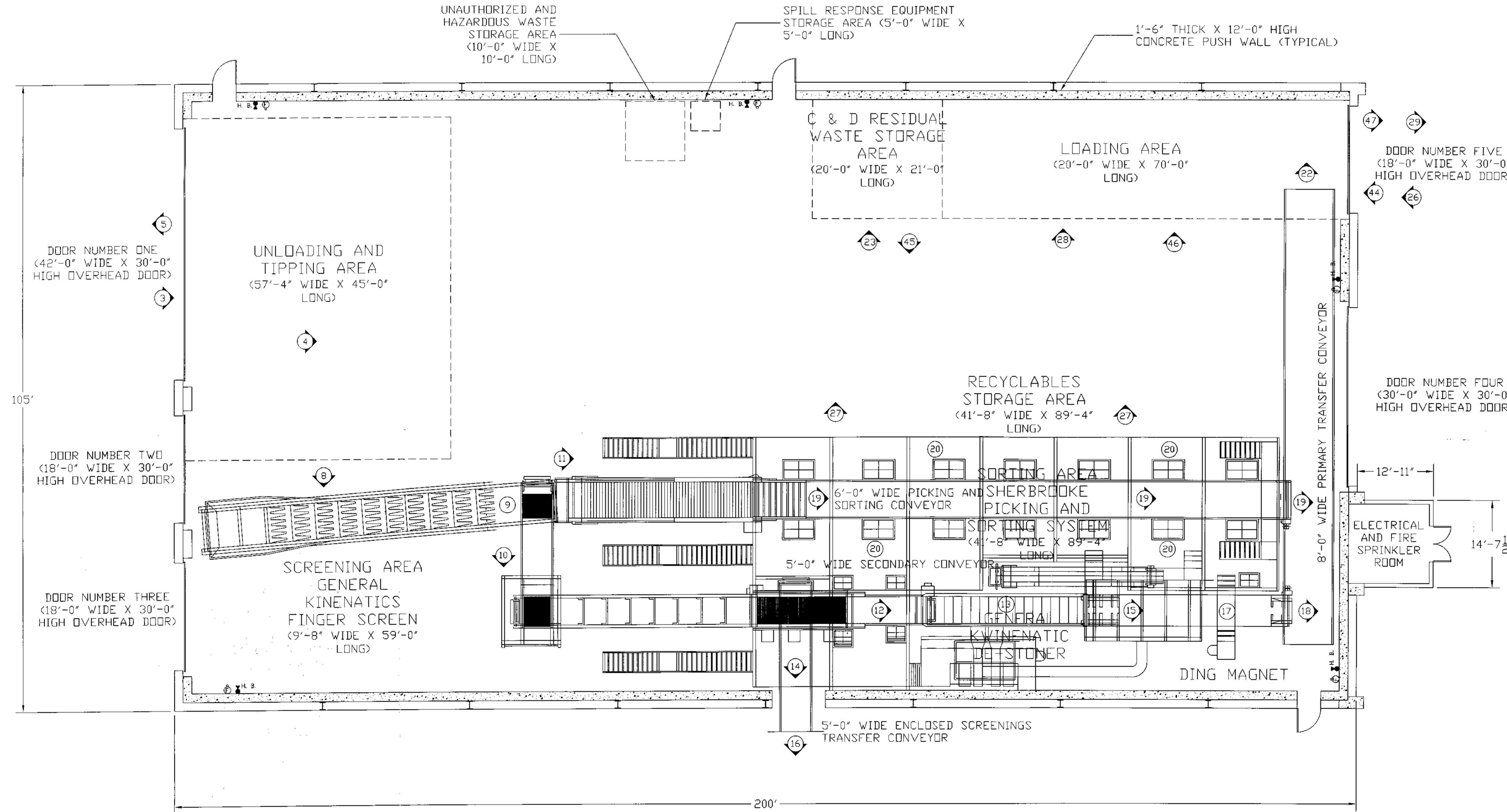

3. PICKUP TRUCKS AND ROLL-OFF TRUCKS TRANSPORTING 10, 20, AND 30 C. Y. CONTAINERS CONTAINING CONSTRUCTION AND DEMOLITION DEBRIS ENTER RECYCLING BUILDING NUMBER TWO AND THE UNLOADING AND TIPPING AREA FOR UNLOADING.
4. CONSTRUCTION AND DEMOLITION DEBRIS MANUALLY UNLOADED OR TIPPED INTO THE UNLOADING AND TIPPING AREA.
5. EMPTY PICKUP TRUCKS AND ROLL-OFF TRUCKS TRANSPORTING EMPTY 10, 20, AND 30 C. Y. CONTAINERS EXIT THE UNLOADING AND TIPPING AREA AND RECYCLING BUILDING NUMBER TWO AFTER UNLOADING CONSTRUCTION AND DEMOLITION DEBRIS.
8. CONSTRUCTION AND DEMOLITION DEBRIS LOADED INTO THE GENERAL KINEMATICS FINGER SCREEN WITH AN EXCAVATOR.
9. CONSTRUCTION AND DEMOLITION DEBRIS SCREENED BY THE GENERAL KINEMATICS FINGER SCREEN TO SEPARATE TWO INCH MINUS AND TWELVE INCH MINUS MATERIAL.
10. CONSTRUCTION AND DEMOLITION DEBRIS SCREENINGS, MATERIAL LESS THAN TWO INCHES IN SIZE PLACED ON THE 5'-0\"/>
- 11. CONSTRUCTION AND DEMOLITION DEBRIS RESIDUAL WASTE, MATERIAL BETWEEN TWO AND TWELVE INCHES IN SIZE PLACED ON THE 6'-0\"/>
- 12. CONSTRUCTION AND DEMOLITION DEBRIS SCREENINGS, MATERIAL LESS THAN TWO INCHES IN SIZE PLACED IN THE GENERAL KINEMATICS DE-STONER BY THE 5'-0\"/>
- 13. THE GENERAL KINEMATICS DE-STONER SEPARATES LIGHT AND HEAVY MATERIAL.
- 14. CONSTRUCTION AND DEMOLITION DEBRIS SCREENINGS, LIGHT MATERIAL LESS THAN TWO INCHES IN SIZE, PLACED ON THE 5'-0\"/>
- 15. HEAVY MATERIAL LESS THAN TWO INCHES IN SIZE PLACED ON THE 5'-0\"/>
- 16. CONSTRUCTION AND DEMOLITION DEBRIS SCREENINGS, MATERIAL LESS THAN TWO INCHES IN SIZE, TRANSFERRED TO RECYCLING BUILDING NUMBER ONE BY THE 5'-0\"/>
- 17. HEAVY MATERIAL LESS THAN TWO INCHES IN SIZE SCREENED FOR FERROUS METAL BY THE DING MAGNET AT END OF THE 5'-0\"/>
- 18. HEAVY MATERIAL LESS THAN TWO INCHES IN SIZE PLACED ON THE 8'-0\"/>
- 19. SCREENED CONSTRUCTION AND DEMOLITION DEBRIS, MATERIAL BETWEEN TWO AND TWELVE INCHES IN SIZE SORTED FOR RECYCLABLES ON THE 6'-0\"/>
- 20. RECOVERED RECYCLABLES DROPPED THROUGH CHUTES INTO THE RECYCLABLES STORAGE AREA BY PICKERS.
- 21. CONSTRUCTION AND DEMOLITION DEBRIS RESIDUAL WASTE LOADED ONTO THE 8'-0\"/>
- 22. CONSTRUCTION AND DEMOLITION DEBRIS RESIDUAL WASTE STOCKPILED AT END OF THE 8'-0\"/>
- 23. CONSTRUCTION AND DEMOLITION DEBRIS STOCKPILED IN CONSTRUCTION AND DEMOLITION DEBRIS RESIDUAL WASTE STORAGE AREA WITH A FRONT-END LOADER.
- 26. ROLL-OFF TRUCKS TRANSPORTING EMPTY 20 AND 40 C. Y. CONTAINERS AND 80 C. Y. TRANSFER TRAILERS ENTER RECYCLING BUILDING NUMBER TWO AND THE LOADING AREA FOR LOADING WITH RECOVERED RECYCLABLES.
- 27. RECOVERED RECYCLABLES REMOVED FROM DESIGNATED STORAGE BIN IN THE RECYCLABLES STORAGE AREA WITH A FRONT-END LOADER FOR LOADING.
- 28. RECOVERED RECYCLABLES LOADED INTO 20 AND 40 C. Y. CONTAINERS TRANSPORTED BY ROLL-OFF TRUCKS AND 80 C. Y. TRANSFER TRAILERS IN THE LOADING AREA WITH A FRONT-END LOADER.
- 29. ROLL-OFF TRUCKS TRANSPORTING FULL 20 AND 40 C. Y. CONTAINERS AND 80 C. Y. TRANSFER TRAILERS CONTAINING RECOVERED RECYCLABLES EXIT THE LOADING AREA AND RECYCLING BUILDING NUMBER TWO.
- 44. EMPTY 100 C. Y. TRANSFER TRAILERS ENTER RECYCLING BUILDING NUMBER TWO AND THE LOADING AREA FOR LOADING WITH CONSTRUCTION AND DEMOLITION DEBRIS RESIDUAL WASTE.
- 45. CONSTRUCTION AND DEMOLITION DEBRIS RESIDUAL WASTE REMOVED FROM THE CONSTRUCTION AND DEMOLITION DEBRIS RESIDUAL WASTE STORAGE AREA WITH A FRONT-END LOADER FOR LOADING.
- 46. CONSTRUCTION AND DEMOLITION DEBRIS RESIDUAL WASTE LOADED INTO 100 C. Y. TRANSFER TRAILERS IN THE LOADING AREA WITH A FRONT-END LOADER.
- 47. 100 C. Y. TRANSFER TRAILERS CONTAINING CONSTRUCTION AND DEMOLITION DEBRIS RESIDUAL WASTE EXIT THE LOADING AREA AND RECYCLING BUILDING NUMBER TWO.

LEGEND

- ⊕ FIRE EXTINGUISHER
- ⊕ H. B. HOSE BIB WITH VACUUM BREAKER VALVE

IT IS A VIOLATION OF SECTION 7209.2 OF THE NEW YORK STATE EDUCATION LAW FOR ANY PERSON, UNLESS THEY ARE ACTING UNDER THE DIRECTION OF A LICENSED PROFESSIONAL ENGINEER TO ALTER ANY ITEM IN ANY WAY. IF ANY ITEM BEARING THE SEAL OF AN ENGINEER IS ALTERED, THE ALTERING ENGINEER SHALL AFFIX HIS SEAL AND A NOTATION "ALTERED BY:" FOLLOWED BY HIS SIGNATURE AND DATE OF SUCH ALTERATION AND A SPECIFIC DESCRIPTION OF THE ALTERATION.

NUMBER	DATE	DESCRIPTION	BY	NUMBER	DATE	DESCRIPTION	BY
1	01/23/06	INCORPORATED NYSDEC 11/03/05 REVIEW COMMENTS	E.G.K.	2	11/20/14	ISSUED FOR NYSDEC SOLID WASTE MANAGEMENT FACILITY PERMIT RENEWAL REVIEW	E.G.K.
REVISIONS							

DESIGNED BY
EUGENE G. KEMPEY
DRAWN BY
EUGENE G. KEMPEY
CHECKED BY
EUGENE G. KEMPEY
APPROVED BY
EUGENE G. KEMPEY P. E.

SEAL

PROGRESSIVE WASTE SOLUTIONS TS OF LI, INC.
1198 PROSPECT AVENUE
WESTBURY, NEW YORK 11590
KEMPEY ENGINEERING
4 BRUNSWICK DRIVE
EAST NORTHPORT, NEW YORK 11731
(631) 368 - 3324

SOLID WASTE MANAGEMENT FACILITY PERMIT RENEWAL
151 PECONIC AVENUE, MEDFORD, NEW YORK 11763
FACILITY PLAN - RECYCLING BUILDING NUMBER TWO

ISSUE DATE:	SCALE:	DRAWING NUMBER:	REVISION NUMBER:	SHEET NUMBER:
11/20/14	1" = 10'	4	2	2 OF 4